

Plat of Survey

of

Lot 59 of the 1st Addition to Bubbling Springs Subdivision,

located in the Southeast 1/4 of Section 34, Town 4 North, Range
16 East, Town of LaGrange, Walworth County, Wisconsin.

Surveyed for: **J B Anderson, Inc.**
W4736 Pebble Drive
Elkhorn, Wisconsin. 53121

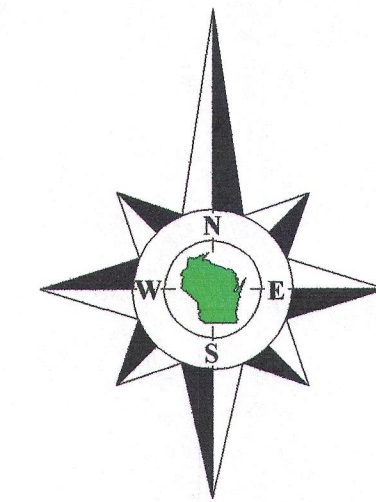

Bearings reference to the plat of the 1st
Addition to Bubbling Springs Subdivision.

Survey Date: January 2, 2015.
Revisions:

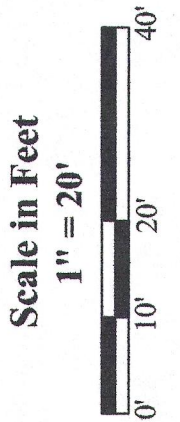

Jensen & Olson Land Surveying, LLC
45 South Wisconsin Street * P.O. Box 322 * Elkhorn, Wisconsin. 53121
Telephone: (262) 723-3434 * Facsimile: (262) 723-8044
Email: jensen.olson@elknet.net



Legend
Found Iron Pipe
Found Iron Rod
Recorded Information
Utility Pole
Concrete Cover
Asphalt Surface
Concrete Surface
Pedestal
Septic Vent

Sheet 1 of 1 Sheets
Drawing Name:
Job Reference Number
2014.113
2014.113

Middle Lake

HB81-28 416-2781

Ridge Road
(66' Wide)

Garage

House
W5717

Lot 59
Tax Parcel
HBS1 00028
0.390 Acre
16,976 Sq.Ft.

Lot 60

Lot 58

Boat House

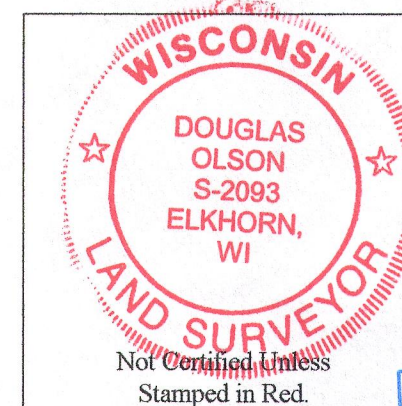

Notes:

- 1) This survey plat is not certified unless signed and sealed in red ink.
- 2) This survey is subject to Wisconsin lien laws. This Plat of Survey is the notice of intent to file lien. Lien waiver required.

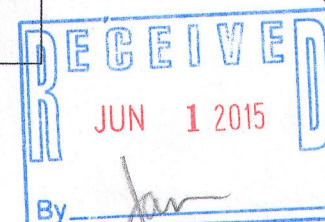

Copyright 2015 by Jensen & Olson Land Surveying, LLC.

All rights reserved. No part of this survey plat may be reproduced or transmitted in any form by any means - graphic, electronic, or mechanical, including photocopying, tracing, or information storage and retrieval systems - without permission in writing from Douglas G. Olson, Jensen & Olson Land Surveying, LLC.

I, Douglas G. Olson, Wisconsin Registered Land Surveyor, do hereby certify that this survey was performed by me, or under my direction in full compliance with the owner's/agent's instructions and Chapter A-E 7 of the Wisconsin Administrative Code "Minimum Standards for Property Surveys"; and that this map is an accurate representation thereof to the best of my knowledge and belief.

Douglas G. Olson
Wisconsin Registered Land Surveyor - 2093